

**For Sale**

**\$ 479,900\***

SELLING PRICE

**Ideal Homes Inc. (414) 324-8203**

# Lot 22 Wyndemere Drive

Pewaukee, Wisconsin



Living Space  
**3281 Sq. Ft.**

Lot Size  
**0.46 Acres**  
**20164 Sq. Ft.**

Overall Home Dims  
**Width: 76'-8"**  
**Depth: 65'-0"**

\* Complete Package Price  
Based on a \$124,900 Lot, Driveway  
& Landscaping not included

## Features

- 3281 Sq. Ft. Total Living Space
- 3-Car Garage
- 2 1/2 Bath
- 3-Bedroom Plan w./ 1st Floor Master Suite
- 2nd Floor Loft
- 1st Floor Study/Den
- 2-Story Foyer
- Kitchen Island w./ Island, Snack Bar, Pantry & Butlers Pantry
- Custom Raised Panel Birch Cabinets
- Granite Countertops
- Stainless Dishwasher & Spacesaver Microwave
- Mud Room w./ Seat & Walk-in-Clos.
- Tray Ceiling @ Master Bedroom
- Master Bath w./ Whirlpool Tub, Custom Tile Shower, Dual Sinks & Cer. Tile Floor
- 13' Greatroom Ceiling
- Split Layout @ 2nd Floor Bath w./ Dual Sinks & Cer. Tile Floor
- Hardwood Flrs Thru-out Foyer, Dinette, Kitchen Dining Room & Mudroom
- Wood Burning Fireplace w./ Stone Veneer & Wood Surround Mantel
- 6-Panel Wood Interior Doors
- 8' Mahogany Double Front Doors
- Knock-Down Drywall Texture w./ Rounded Corners
- 9'-0" First Floor Ceilings
- 2"x6" - 16" o.c. Exterior Walls
- R-45 Ceiling
- 9'-0" Poured Basement Walls w./ Brick Texture
- Armstrong 90% High Efficient Heating Unit
- Central Air Conditioning
- Maintenance Free Vinyl Windows w./ Grids
- Dimensional Roof Shingles
- Stucco Vener, Stone Veneer, Cement Brd.
- Siding & Wood Textured Composite Trim Boards

## 2ND FLOOR PLAN

**\$355,000 MODEL PRICE**

- Model Price Based on the Princeton Model As Built - (no hidden extras)

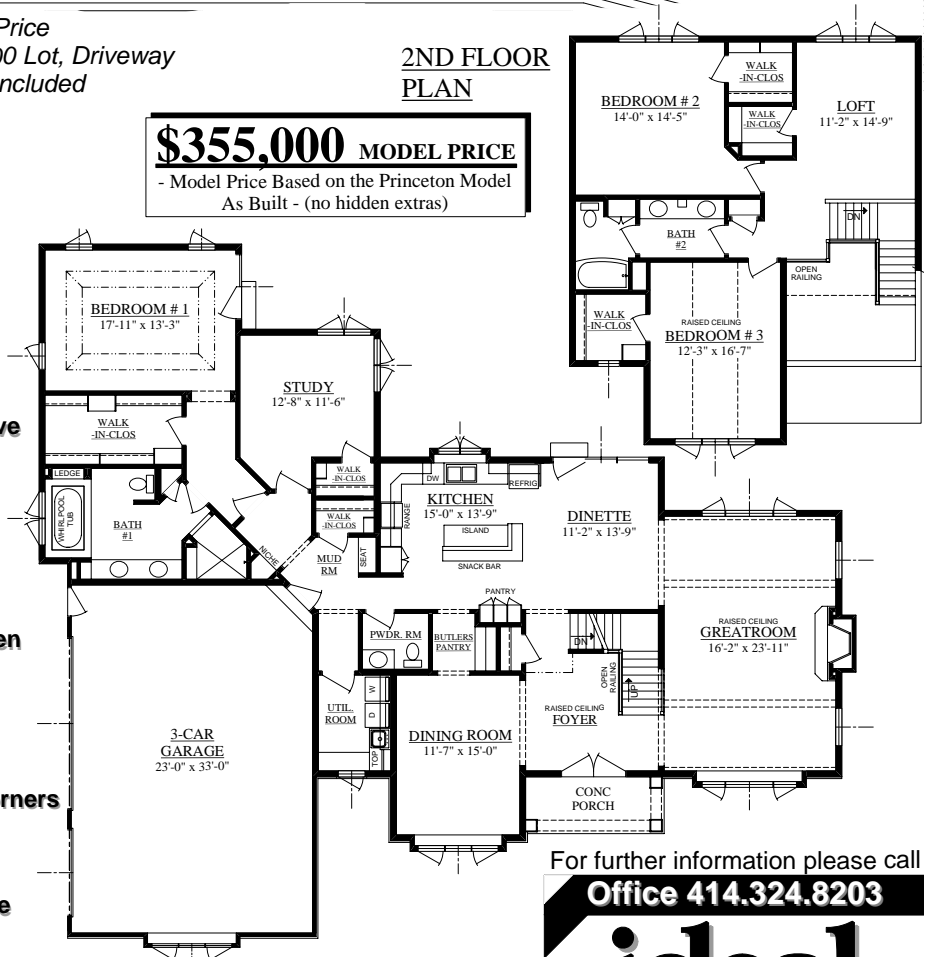

For further information please call  
**Office 414.324.8203**

# ideal HOMES

**INC.**  
We Specialize in Custom Homes  
www.theidealhome.com

**P.O. Box 786**  
**Hales Corners, WI 53130**



## The "Princeton" - Wyndemere -

Copyright: It is unlawful for anyone to use or copy these plans without the express written permission of Ideal Homes. Consult construction plans for complete dimensions. Prices and specifications subject to change without notice. All dimensions are approximate, and are subject to change. Builder reserves the right to change specifications for the purpose of improving the product.